

Standard Series Ventilator Unit VN 410 Power Supply: 400V/3N~ 50 Hz with Size: 4

**FISCHBACH
COMPACT
FAN
HD500/D2.5**

Pressure/Air Volume Performance, Selection of Speed Controllers

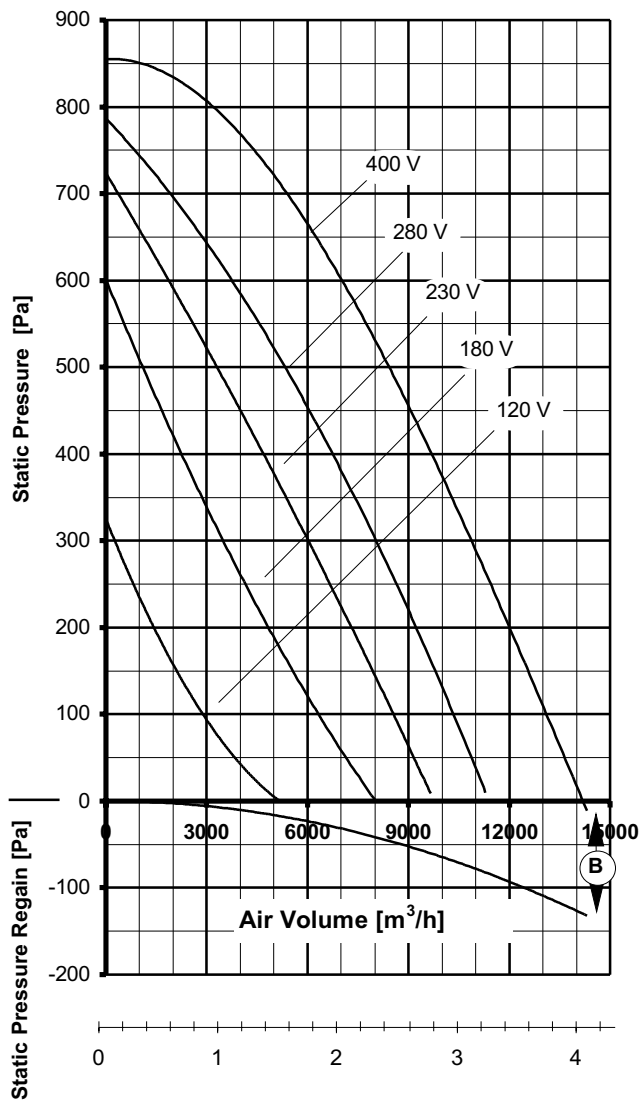
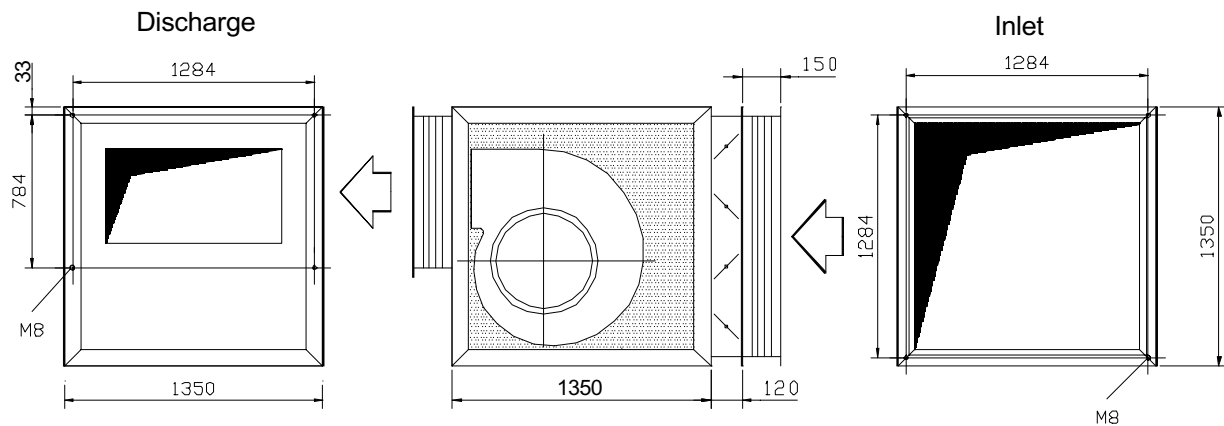

The data for external static pressure take into account all pressure losses due to integration of the fan within unit. Performance based upon free inlet and discharge.

Max. power consumption 3,7 kW

Max. current consumption 7,83 A

$I_A / I_N: 1,9$

Static Pressure Regain (B) can be read from the performance curve. It is available when the unit is fitted with a straight discharge duct, sized according to the standard connection size B. Minimum duct length necessary: 3,50 m.

Voltage [V]	At free air [m³/h]	External static pressure Δp_{st} [Pa] available for AHU and system pressure losses						
		200	300	400	500	600	700	800
		1st. line: Air Volume V_L [m³/h] at $\rho = 1,2 \text{ kg}$ 2nd. line: Current consumption [A]						
120	5170 4,50	1425 3,99						
180	8020 6,03	4840 5,61	3490 5,20	2250 4,79	1195 4,15			
230	9760 6,77	7310 6,38	6025 6,05	4700 5,63	3310 5,09	1870 4,42		
280	11390 7,16	6230 6,82	8030 6,56	6750 6,22	5335 5,78	3750 5,20	1920 4,41	
400	14190 7,83	12005 7,60	10885 7,45	9690 7,26	8420 7,04	7025 6,76	5100 6,39	3200 5,81

Save power and even more silent with FISCHBACH SPEED CONTROLLERS

Voltage Control / Frequency Control	Type	Order-No.
Stepless, 0 - 100 % and 100 - 0 % *	FDR 120/3	6233
Stepwise, 5 Steps *	FDR 11.3/3	6185
FISCHBACH AUTOMATIC CONTROL *	FRA 120/3	6283
Frequency Inverter *	FFU 80	6301

* with integrated motor protection and outlet fuses

Max. permissible Air Inlet Temperature: 60°C