

Standard Series Ventilator Unit VN 411 Power Supply: 400V/3N~ 50 Hz with Size: 4

**FISCHBACH
COMPACT
FAN
HD560/D5**

Pressure/Air Volume Performance, Selection of Speed Controllers

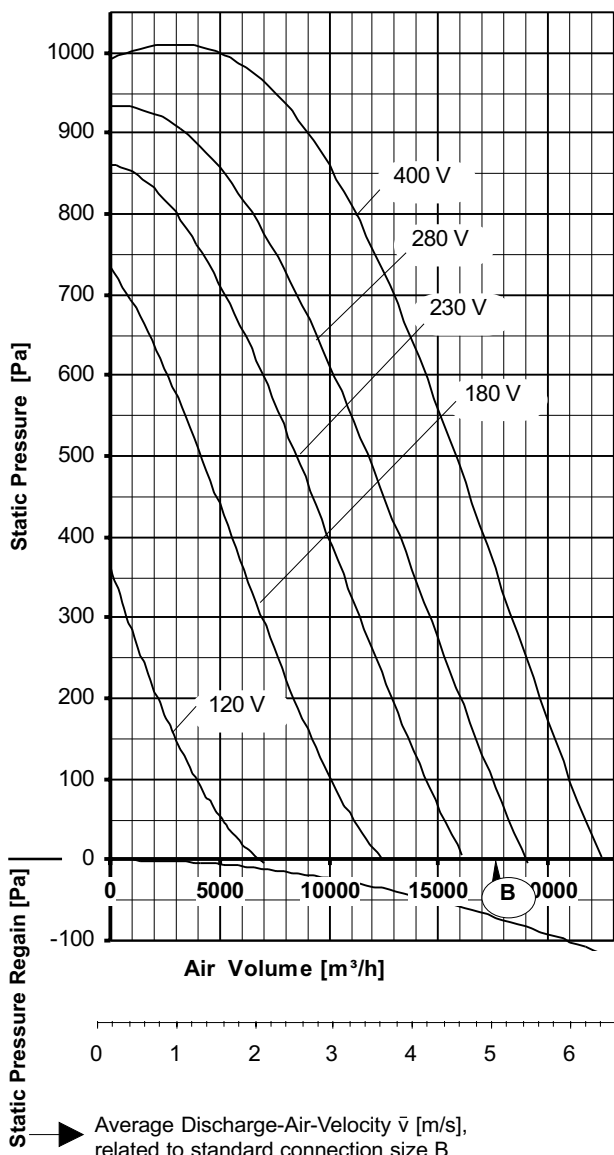
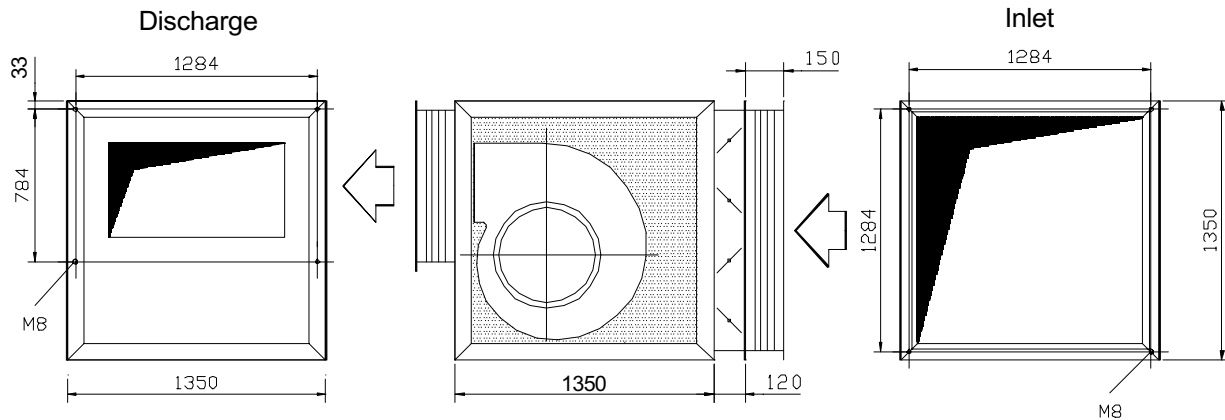

Max. permissible Air Inlet Temperature: 60°C

The data for external static pressure take into account all pressure losses due to integration of the fan within unit. Performance based upon free inlet and discharge.

Max. power consumption 7,9 kW
Max. current consumption 16,13 A

$I_A / I_N: 2,9$

Static Pressure Regain (B) can be read from the performance curve. It is available when the unit is fitted with a straight discharge duct, sized according to the standard connection size B. Minimum duct length necessary: 2,50 m.

Voltage [V]	At free air [m³/h]	External static pressure Δp_{st} [Pa] available for AHU and system pressure losses						
		200	400	500	600	700	800	900
	and [A]	1st. line: Air Volume V_L [m³/h] at $\rho = 1,2 \text{ kg}$						
		2nd. line: Current consumption [A]						
120	6855 10,80	2175 10,16						
180	12505 14,67	8400 13,98	5555 12,64	4150 11,72	2640 10,53			
230	16180 16,13	12875 15,33	9980 14,17	8525 13,42	6985 12,52	5250 11,36		
280	18955 15,89	16050 15,37	13215 14,54	11745 13,98	10200 13,30	8500 12,44	6510 11,29	
400	22305 15,19	19765 14,84	17155 14,36	15785 14,05	14344 13,70	12790 13,27	11050 12,74	8975 12,04

Save power and even more silent with FISCHBACH SPEED CONTROLLERS

Voltage Control / Frequency Control	Type	Order-No.
Stepless, 0 - 100 % and 100 - 0 % *	FDR 200/3	6235
Stepwise, 5 Steps *	FDR 20/3	6177
FISCHBACH AUTOMATIC CONTROL *	FRA 200/3	6285
Frequency Inverter *	FFU 180	6314

* with integrated motor protection and outlet fuses