

Series: COMPACT-FAN Type CE
 EC-MOTOR
 single inlet
 with forward curved blades

FISCHBACH
 Luft- und Ventilatorentechnik GmbH

Type: CE790/EM35

ERP KONFORM

CE -conform



Forgalmazó:
 Oxyma Systems Kft.
 3433 Nyékládháza, Ady Endre u. 49/A

phone: +36 (30) 665-5982
 internet: www.fischbach-air.hu
 email: oxyma@oxyma.hu

Technical Data

weight: (kg) 27
 material housing: steel, galvanized
 material impeller: steel, galvanized
 direction of rotation: left/right
 protection class: IP 65
 insulation class: F
 motor protection: thermal contact

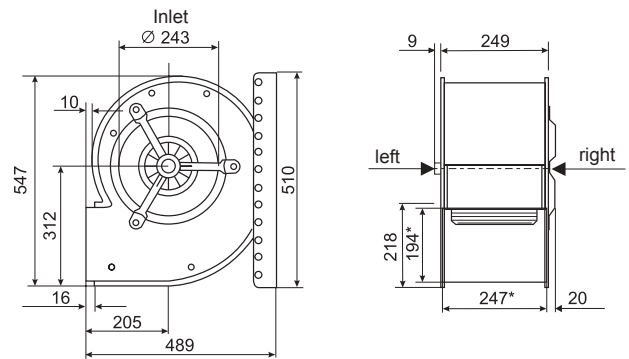

*external dimension of discharge

**connection plan*
 FFU-EC 230**

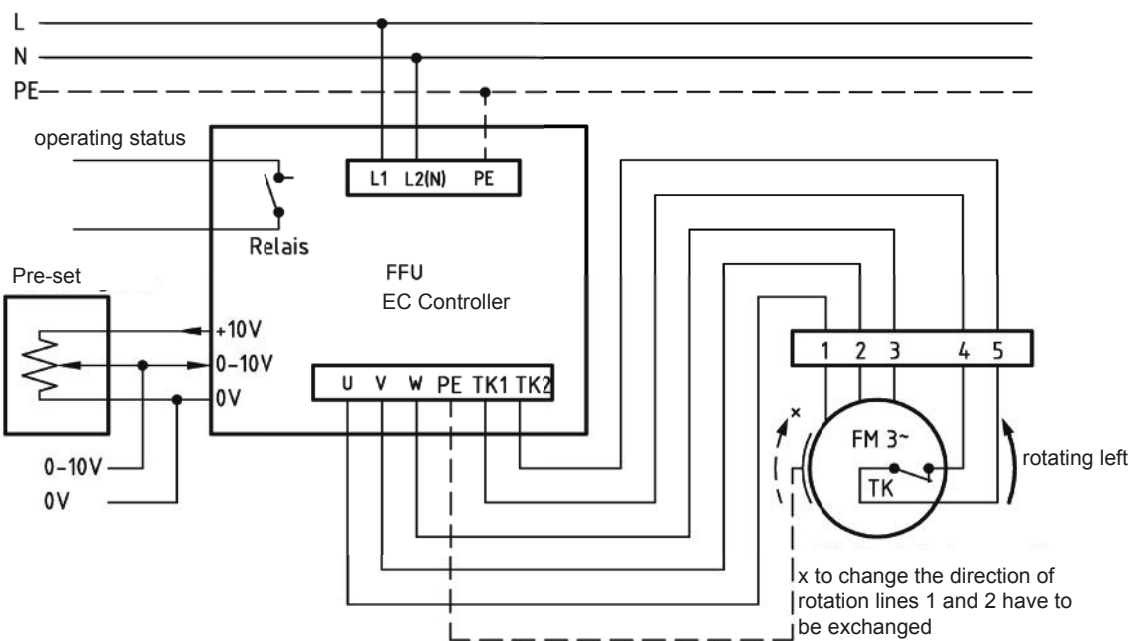

* Connection only according to the enclosed technical documentation.

the silent one



Series: COMPACT-FAN Type CE
EC-MOTOR
 single inlet
 with forward curved blades

FISCHBACH
 Luft- und Ventilatorentechnik GmbH

Type: CE790/EM35

Erp 2013 2015 2018 x

Performance data

main voltage:	(V)	230 (1~)
frequency:	(Hz)	50
current max.:	(A)	9,2
power input max.:	(kW)	1,4
air flow volume max.:	(m³/h)	4380
statical pressure max.:	(Pa)	496
speed max.:	(rpm)	1350
supply air temperature:	(°C)	-25... +50
capacitor:	(µF)	-

ErP-Data:

total efficiency fan (η_e):	(%)	45,2
installation category:		A
efficiency category:		static
efficiency grade: N	(%)	42
target efficiency (η_{target}):	(%)	39,1
speed controller		yes
year of manufacturing		since 2015
manufacturer:	Fischbach Luft- und Ventilatorentechnik GmbH D-57290 Neunkirchen / HRB 5804 Siegen	
order no. (left/right)		18121050/18121350
power input:	(kW)	0,63
air flow volume:	(m³/h)	1997
statical pressure:	(Pa)	466
speed:	(rpm)	1350
specific ratio:		1

disassembling/recycling/disposal: see page decommission
 installation/operation/maintenance: see operating and mounting instructions
 measurement for determination of efficiency without additional items

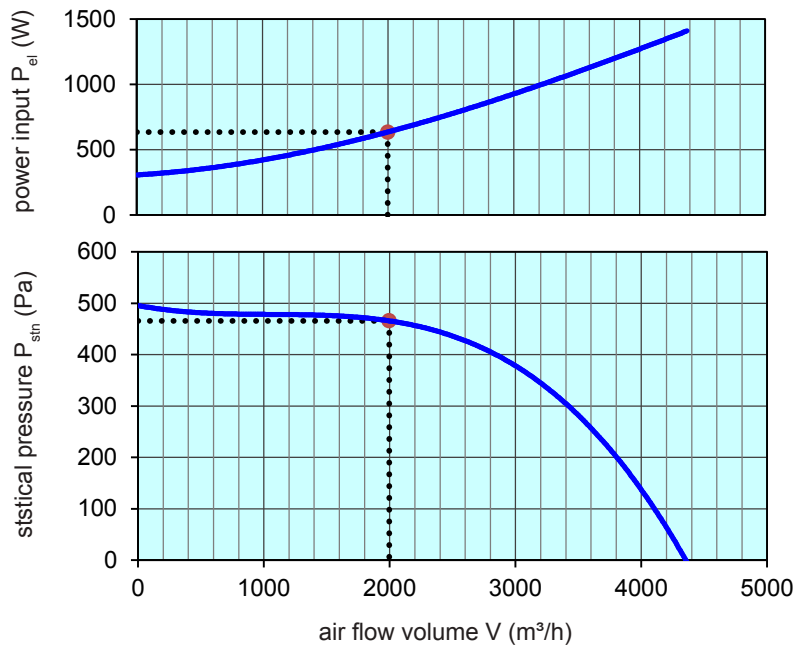

control with	type	order-Nr.
FISCHBACH-frequency-converter	FFU1-21-2.2	63720
FISCHBACH-Pre-set 0-10V (optional accessories)	FS10	69460

Technical documentation according to page: **General information**