

**Series:** COMPACT-FAN Type D/DS

double inlet  
with forward curved blades

**FISCHBACH**

Luft- und Ventilatorentechnik GmbH

**Type:** D440/E15-R

ERP KONFORM

CE -conform



**Forgalmazó:**

Oxyrna Systems Kft.  
3433 Nyékládháza, Ady Endre u. 49/A

phone: +36 (30) 665-5982  
internet: www.fischbach-air.hu  
email: oxyrna@oxyrna.hu

**Technical Data**

|                        |                   |    |
|------------------------|-------------------|----|
| weight:                | (kg)              | 13 |
| material housing:      | steel, galvanized |    |
| material impeller:     | steel, galvanized |    |
| direction of rotation: | left              |    |
| protection class:      | IP 65             |    |
| insulation class:      | F                 |    |
| motor protection:      | thermal contact   |    |

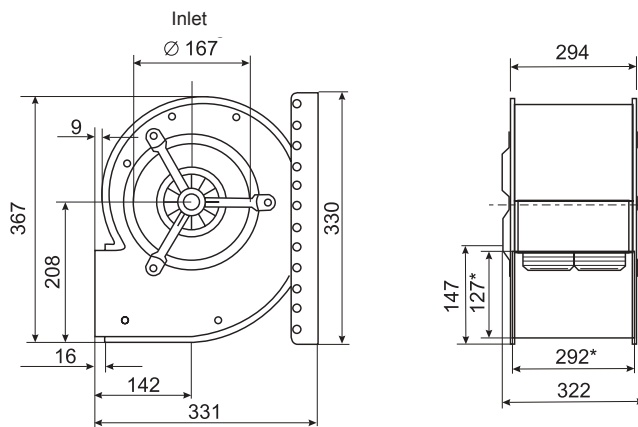

\*external dimension of discharge

**connection plan**

0.11-1 I.

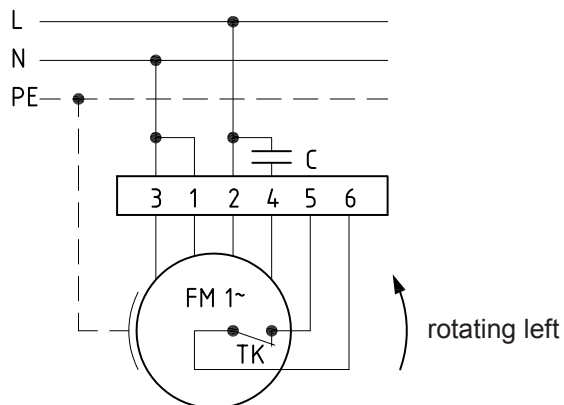

the silent one



**Series: COMPACT-FAN Type D/DS**

double inlet  
with forward curved blades

**FISCHBACH**

Luft- und Ventilatorentechnik GmbH

**Type: D440/E15-R**

Erp 2013\*\*x 2015 2018

**Performance data**

|                         |        |           |
|-------------------------|--------|-----------|
| main voltage:           | (V)    | 230 (1~)  |
| frequency:              | (Hz)   | 50        |
| current max.:           | (A)    | 1,7       |
| power input max.:       | (kW)   | 0,36      |
| air flow volume max.:   | (m³/h) | 2200      |
| statical pressure max.: | (Pa)   | 320       |
| speed max.:             | (rpm)  | 1426      |
| supply air temperature: | (°C)   | -25...+60 |
| capacitor:              | (µF)   | 8         |

\*\* not suitable for distribution in EU countries, please choose an appropriate EC fan or contact our technical department

**ErP-Data:**

|  |   |            |
|--|---|------------|
| total efficiency fan ( $\eta_e$ ):     | (%)   | 27,1       |
| installation category:                 |   | A          |
| efficiency category:                   |   | static     |
| efficiency grade: N                    | (%)   | 37         |
| target efficiency ( $\eta_{target}$ ): | (%)   | 26,6       |
| speed controller                       |   | no         |
| year of manufacturing                  |   | since 2015 |
| manufacturer:                          | Fischbach Luft- und Ventilatorentechnik GmbH<br>D-57290 Neunkirchen / HRB 5804 Siegen |            |
| order no.                              |   | 18011843   |
| power input:                           | (kW)  | 0,23       |
| air flow volume:                       | (m³/h)  | 1045       |
| statical pressure:                     | (Pa)  | 215        |
| speed:                                 | (rpm)   | 1388       |
| specific ratio:                        |   | 1          |

disassembling/recycling/disposal: see page decommission

installation/operation/maintenance: see operating and mounting instructions

measurement for determination of efficiency without additional items

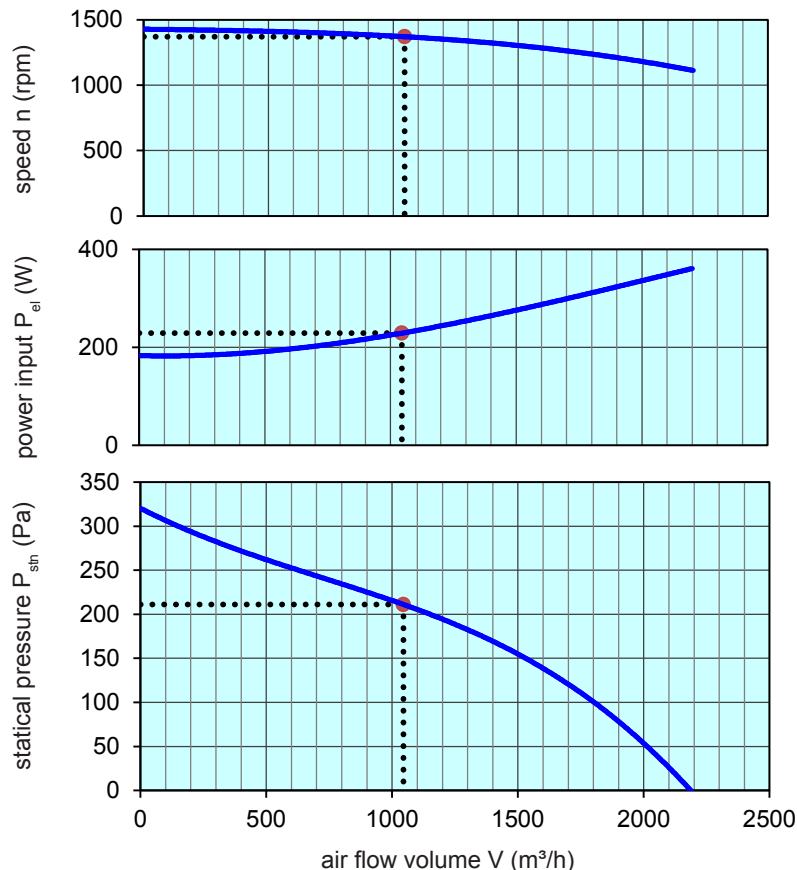

Speed controller / accessories / sound data, please see in the appropriate table

Technical documentation according to page: **General information**