

Series: COMPACT-FAN Type D/DS

double inlet
with forward curved blades

FISCHBACH

Luft- und Ventilatorentechnik GmbH

Type: DS8-970/D2

ERP KONFORM

CE -conform



Forgalmazó:

Oxyma Systems Kft.
3433 Nyékládháza, Ady Endre u. 49/A

phone: +36 (30) 665-5982
internet: www.fischbach-air.hu
email: oxyma@oxyma.hu

Technical Data

| | | |
|------------------------|-------------------|----|
| weight: | (kg) | 64 |
| material housing: | steel, galvanized | |
| material impeller: | steel, galvanized | |
| direction of rotation: | left | |
| protection class: | IP 65 | |
| insulation class: | F | |
| motor protection: | thermal contact | |

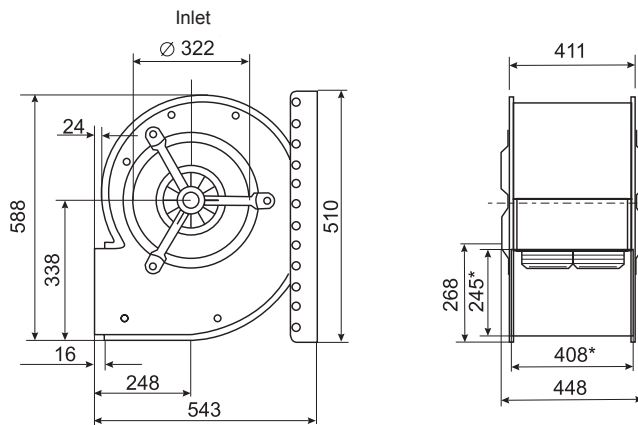

*external dimension of discharge

connection plan
0.13-2 I.

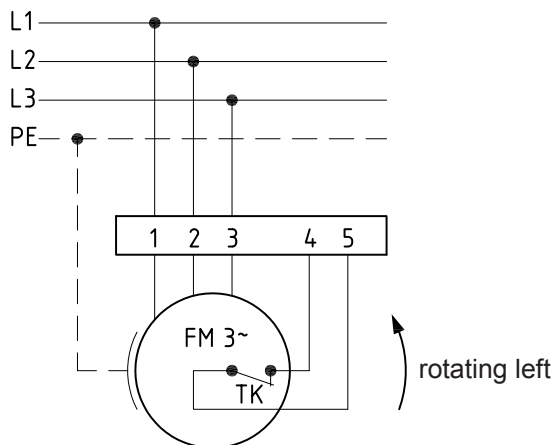

the silent one

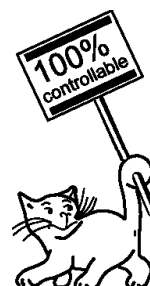

Series: COMPACT-FAN Type D/DSdouble inlet
with forward curved blades**FISCHBACH**

Luft- und Ventilatorentechnik GmbH

Type: DS8-970/D2

ErP 2013 2015 x 2018

Performance data

| | | |
|-------------------------|--------|-----------|
| main voltage: | (V) | 400 (3~) |
| frequency: | (Hz) | 50 |
| current max.: | (A) | 6,5 |
| power input max.: | (kW) | 3,1 |
| air flow volume max.: | (m³/h) | 7850 |
| statical pressure max.: | (Pa) | 801 |
| speed max.: | (rpm) | 1287 |
| supply air temperature: | (°C) | -25...+60 |
| capacitor: | (µF) | - |

ErP-Data:

| | | |
|--|---|------------|
| total efficiency fan (η_e): | (%) | 41,2 |
| installation category: | | A |
| efficiency category: | | static |
| efficiency grade: N | (%) | 44 |
| target efficiency (η_{target}): | (%) | 39,3 |
| speed controller | | yes |
| year of manufacturing | | since 2015 |
| manufacturer: | Fischbach Luft- und Ventilatorentechnik GmbH D-57290 Neunkirchen / HRB 5804 Siegen | |
| order no. | | 18012072 |
| power input: | (kW) | 1,8 |
| air flow volume: | (m³/h) | 3920 |
| statical pressure: | (Pa) | 637 |
| speed: | (rpm) | 1195 |
| specific ratio: | | 1 |

disassembling/recycling/disposal: see page decommission

installation/operation/maintenance: see operating and mounting instructions

measurement for determination of efficiency without additional items

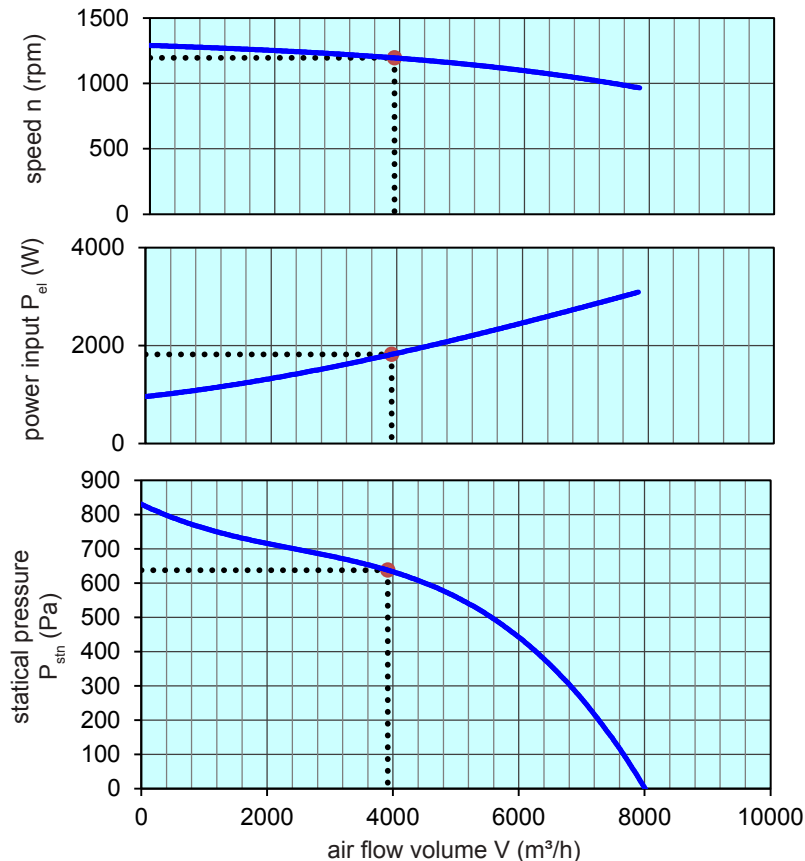

Speed controller / accessories / sound data, please see in the appropriate table

Technical documentation according to page: **General information**